

NOTES:

WIRING:

RED = +12VDC
BLACK = GND
WHITE = +12VDC (OPEN), 0VDC (CLOSE)

Parts List			
ITEM	QTY	PART NUMBER	DESCRIPTION
1	1	EP61C10310	EVX ACT 4S WWC 3W
2	1	EVP30001	EV U-PIN
3	1	MEVX300HX	MEVX 3" STUBBY VALVE ONLY

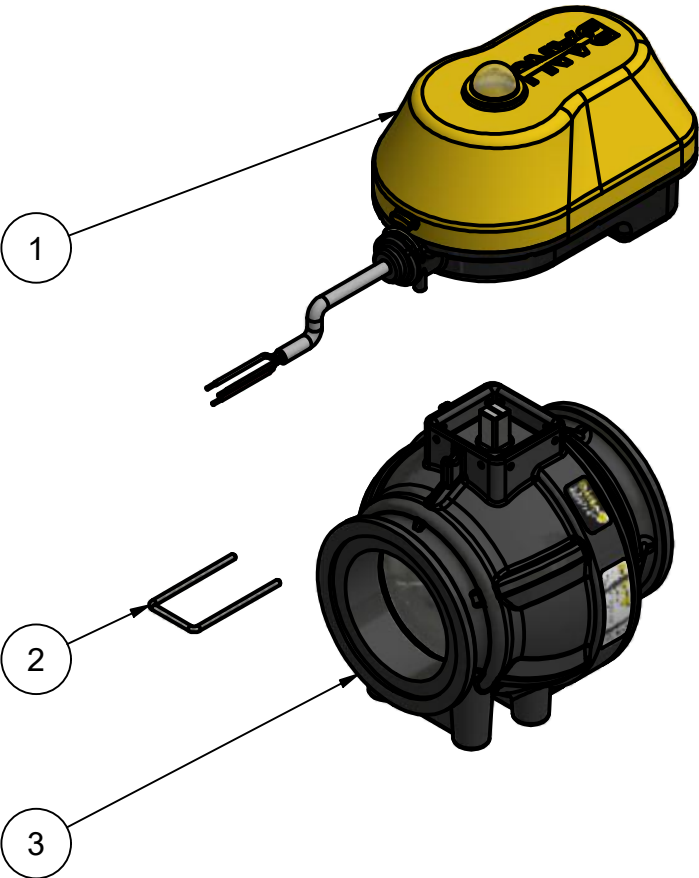

THIS DRAWING AND ALL INFORMATION CONTAINED THEREON ARE THE EXCLUSIVE PROPERTY OF BANJO CORPORATION.

UNLESS SPECIFICALLY NOTED, THIS DRAWING AND ITEMS SHOWN ON THIS DRAWING ARE SUBJECT TO CHANGE AT ANY TIME.



BANJO CORPORATION
150 BANJO DRIVE, CRAWFORDSVILLE, IN 47933
WEB SITE: WWW.BANJOCORP.COM
E-MAIL: BANJOSALES@IDEXCORP.COM

DESCRIPTION	MEVX 3"FP 4S WWC 3W
PART NUMBER	MEVX300